

**SCHEDA COMANDO**  
CONTROL BOARD  
**CARTE DE COMMANDE**  
STEUERPLATINE  
TARJETA DE MANDO

**ZBX7**

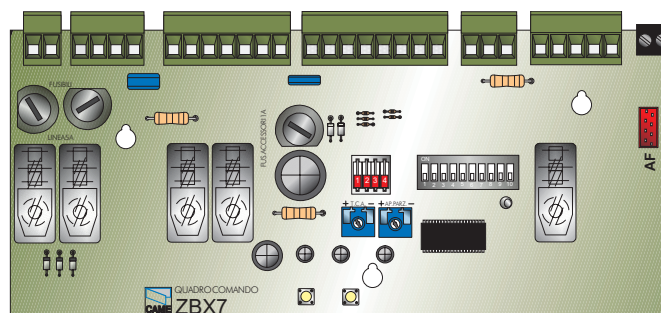

**ITALIANO**

## CARATTERISTICHE GENERALI

### Descrizione scheda

La scheda comando ZBX7 è adatta al comando di automazioni scorrevoli alimentati a 230V monofase della serie BX-A/BX-B.

La scheda va inserita e fissata nel contenitore porta-schede del motoriduttore (vedi descrizione montaggio a pag.12), ed alimentata con una tensione di 230V (a.c.) nei morsetti L1 e L2.

É protetta in ingresso con due fusibili da 5A, mentre i dispositivi di comando a bassa tensione (24V) sono protetti con fusibile da 1A.

La potenza complessiva degli accessori (24V) non deve superare i 20W.

### Sicurezza

Le fotocellule possono essere collegate e predisposte per:

- Riapertura in fase di chiusura (2-C1), le fotocellule rilevando un ostacolo durante la fase di chiusura del cancello, provocano l'inversione di marcia fino alla completa apertura;
- Stop parziale, arresto del cancello se in movimento con conseguente predisposizione alla chiusura automatica (2-C3);
- Stop totale (1-2), arresto del cancello con l'esclusione del ciclo di chiusura automatica, per riprendere il movimento del cancello, agire sulla pulsantiera o sul radio-comando;

### Description of control panel

The ZBX7 control board is used as a remote control for BX-A/BX-B series 230V single-phase automated sliding gates.

The board is introduced and fixed in place in the gearmotor's circuit board holder (see assembly description on page 12), at 230V (a.c.) in terminals L1 and L2.

The inlet is protected with two 5A fuses, while the low voltage (24V) control devices are protected with a 1A fuse. The accessories' total capacity (24V) should not exceed 20W.

### Safety

Photocells can be connected to obtain:

- Re-opening during closure (2-C1), if the photocells identify an obstacle while the gate is closing, they will reverse the direction of movement until the gate is completely open;
  - Partial stop, shutdown of moving gate, with activation of an automatic closing cycle (2-C3);
  - Total stop (1-2), shutdown of gate movement without automatic closing; a pushbutton or radio remote control must be actuated to resume movement).
- N.B:** If an NC safety contact (2-C1, 2-C3, 1-2) is opened, the LED (pag.14 -n°10) will flash to indicate this fact;

- Obstacle presence detection. When the motor is stopped (gate is closed, open or half-open after an emergency stop command), the transmitter and the control pushbutton will be deactivated if an obstacle is detected by one of the safety devices (for example, the photocells);

### Accessories which can be connected to this unit

- Item. 001B4336 optical reader, detects obstacles during the gate's movement; during the opening phase, the gate stops and then begins a closing movement after the automatic closure count, whilst during closure the direction of movement is inverted.

Warning: during closure, if obstacles are detected three times consecutively, the gate will remain open and automatic closure will be discontinued. To resume the gate's movement, use the push-button panel or the remote control;

- Cycle lamp. The lamp which lights the manoeuvring zone: it remains lit from the moment the doors begin to open until they are completely closed (including the time required for the automatic closure). In case automatic closure is not enabled, the lamp remains lit only during movement.

The function of the cycle lamp is obtained in output W-E1 only if dip switch numbers: 1 "automatic closing" and No. 6 "detect obstacle presence" are set to ON (see page 16).

## Other functions

- Automatic closing. The automatic closing timer is automatically activated at the end of the opening cycle. The preset, adjustable automatic closing time is automatically interrupted by the activation of any safety system, and is deactivated after a STOP command or in case of power failure;
- Partial opening. Gate opening for passage on foot is activated by connecting to the 2-3P terminal blocks and it can be adjusted by the AP.PARZ. trimmer. By using this function, automatic closure varies as follows:
  - 1) Dip 1 ON - Automatic closure activated.
    - after a partial opening, the closure time does depend on any adjustment of the TCA trimmer.
  - 2) Dip 1 OFF - Automatic closure deactivated.
    - If the TCA trimmer is set to the **minimum**, after a partial opening, automatic closure counting does not begin;
    - If the TCA trimmer is set to the **maximum**, after a partial opening, closing time is set to 8 seconds.
- "Operator present". Gate operates only when the pushbutton is held down (the radio remote control system is deactivated);
- Slowing at the limit switch.

**FUNCTION AVAIABLE ONLY FOR GATES  
WEIGHING UP TO 300 KG, OTHERWISE IT  
MUST BE DISACTIVATED**

The gate slows down before the opening or closing movement is completed.

Only works with the optical reader on. After every opening and closing of the safety door or after restoring the voltage, the slowing function is active from the 2<sup>nd</sup> command onwards.

- Pre-flashing. After an opening or closing command, the flasher connected to the W-E1 flashes for 5 seconds before beginning the procedure;
- Closing command. Function of closing the gate only, with a wireless control device connected to contact 2-7, set dip 1 to ON (4-way module), see page 22;
- Opening command. Function of opening the gate only, with a wireless control device connected to contact 2-3P, set dip 2 to ON (4-way module), see page 22;
- Type of command:
  - Open-stop-close-stop by button and transmitter;
  - Open-close by button and transmitter;
  - Open only by transmitter.

## Adjustments

- Automatic closure time;
- Partial opening time.

**IMPORTANT: Shut off the mains power before servicing the inside of the unit.**

**ITALIANO**

- Aprire lo sportello accesso sblocco, allentare la vite del coperchio quadro comando e levarlo (1).
- Rimuovere il copri-scheda dalla piastra di supporto quadro comando (2).
- Agganciare e fissare la scheda ZBX7 nella piastra di supporto quadro comando con le viti predisposte (3).
- Riposizionare il supporto copri-schede (4).
- Procedere al collegamento elettrico, fissare il coperchio del quadro comando e chiudere lo sportello accesso sblocco (5).

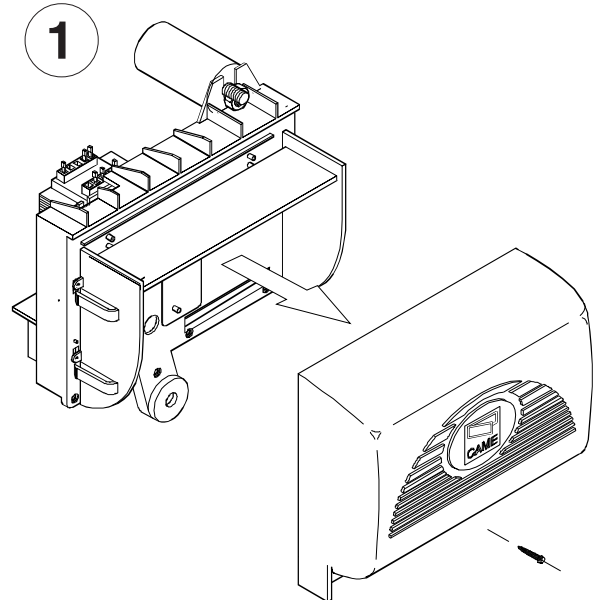

**ENGLISH**

- Open the release access door, loosen the screws of the control panel cover and lift it (1).
- Remove the circuit board cover from the control panel support plate (2).
- Hook and fix the ZBX7 board to the control panel support plate with the appropriate screws (3).
- Reposition the circuit board cover support (4).
- Proceed with the electric connection, replace the control panel cover and close the release access door (5).

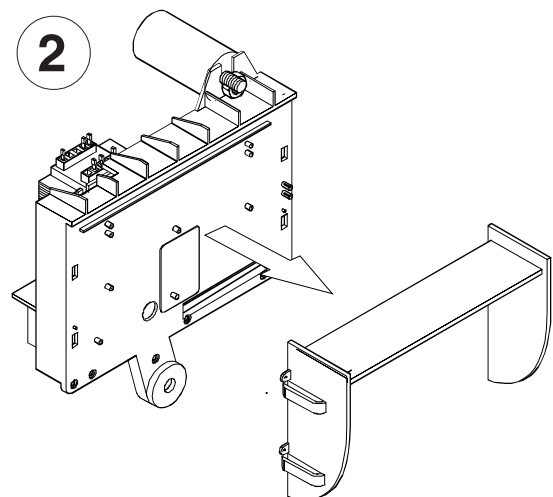

**FRANÇAIS**

- Ouvrir le volet d'accès au déblocage, desserrer la vis du couvercle de l'armoire de commande et l'enlever (1).
- Enlever le protège-carte de la plaque qui soutient l'armoire de commande (2).

-Accrocher et fixer la carte ZBX7 dans la plaque qui soutient l'armoire de commande avec les vis prévues à cet effet (3).

-Remettre le support protège-cartes (4).

-Effectuer le branchement électrique, fixer le couvercle de l'armoire de commande et refermer le volet d'accès au blocage (5).

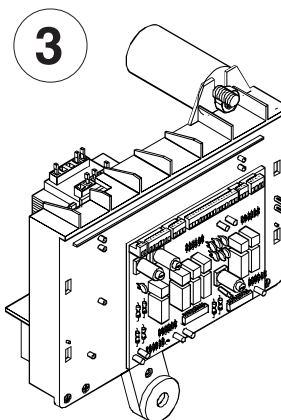

#### DEUTSCH

-Öffnen Sie die Klappe, die Zugriff auf die Schalttafel gibt. Lösen Sie die Schrauben von der Abdeckung der Schalttafel und nehmen Sie die Abdeckung ab (1).

-Nehmen Sie die Kartenabdeckung von der Halterungsplatte der Schalttafel ab (2).

-Stecken Sie die Karte ZBX7 in die Halterungsplatte der Schalttafel und befestigen Sie die mit den entsprechenden Schrauben (3).

-Bringen Sie die Kartenabdeckung wieder an (4).

-Führen Sie den Stromanschluß durch. Bringen Sie dann die Abdeckung wieder auf der Schalttafel an und schließen Sie die Klappe wieder (5).

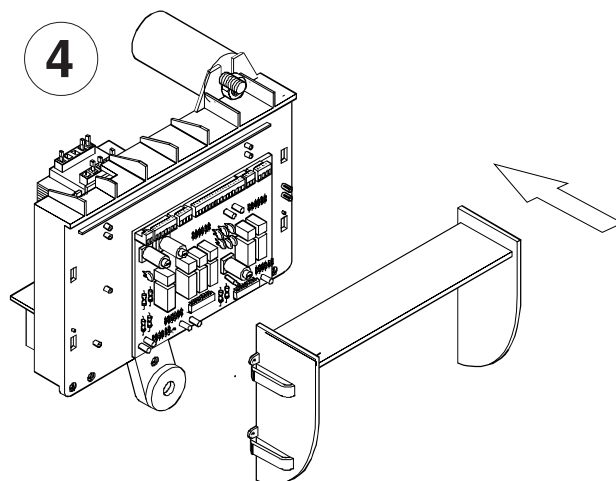

#### ESPAÑOL

-Abra la puerta de acceso al desbloqueo, afloje el tornillo de la tapa del cuadro de mando y quítelo (1).

-Quite el cubretarjeta de la placa de soporte del cuadro de mando (2).

-Enganche y fije la tarjeta ZBX7 a la placa de soporte del cuadro de mando, con los tornillos suministrados (3).

-Vuelva a colocar el soporte cubretarjeta (4).

-Realice la conexión eléctrica, fije la tapa del cuadro de mando y cierre la puerta de acceso al desbloqueo (5).

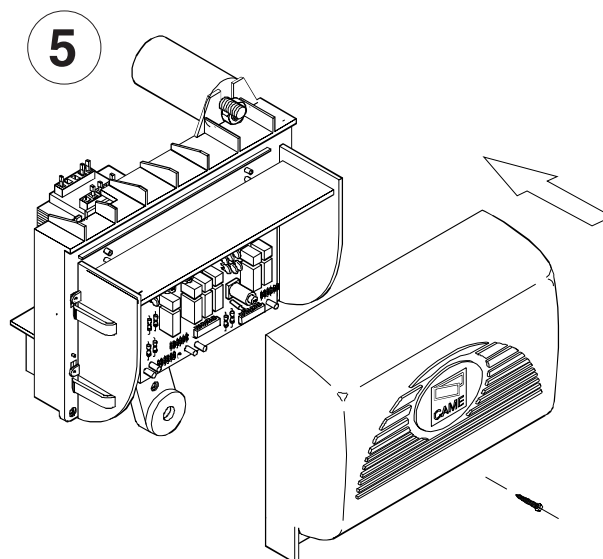

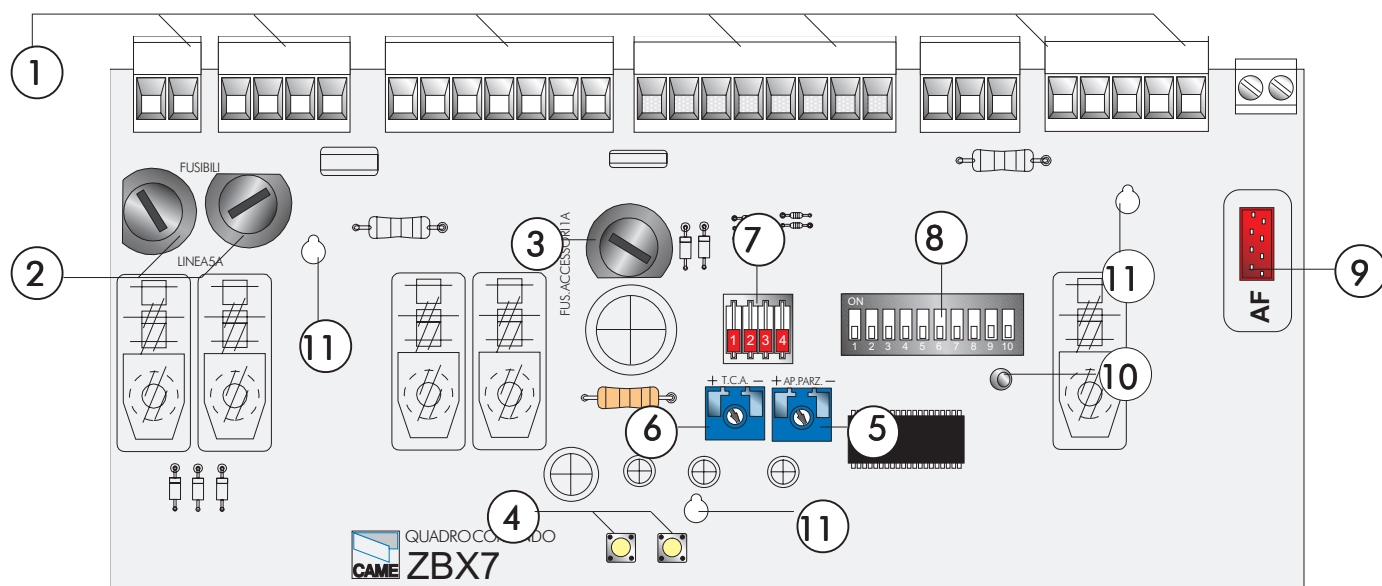

ITALIANO

COMPONENTI PRINCIPALI

- 1 Morsettiere di collegamento
- 2 Fusibili di linea 5A
- 3 Fusibile accessori 1A
- 4 Pulsanti di memorizzazione codice radio
- 5 Trimmer di regolazione apertura parziale
- 6 Trimmer di regolazione tempo di chiusura automatica
- 7 Selettore funzioni a 4 dip (vedi pag.22)
- 8 Selettore funzioni a 10 dip (vedi pag.19)
- 9 Innesto scheda radiofrequenza (vedi tabella)
- 10 LED segnalazione
- 11 Asolature per fissaggio scheda

**ENGLISH****MAIN COMPONENTES**

- 1 Terminal block for external connections
- 2 Line fuse, 5A
- 3 Fuse on accessory power line, 1A
- 4 Radio-code save buttons
- 5 Trimmer for adjustment operating time
- 6 Trimmer for adjustment automatic closing
- 7 4-dip function switch (see pag.22)
- 8 10-dip function switch (see pag.19)
- 9 Socket AF radiofrequency board (see table)
- 10 Signal LED
- 11 Grooves for board positioning

**FRANÇAIS****PRINCIPAUX COMPOSANTS**

- 1 Plaque à bornes de connexion
- 2 Fusible de ligne 5A
- 3 Fusible accessoires 1A
- 4 Boutons-poussoir mémorisation code radio
- 5 Trimmer de réglage temps de fonctionnement
- 6 Trimmer de réglage fermeture automatique
- 7 Selecteur de fonctions à 4 interrupteurs à positions multiples (voir pag.22)
- 8 Selecteur de fonctions à 10 interrupteurs à positions multiples (voir pag.19)
- 9 Branchement carte radiofréquence AF (voir tableau)
- 10 LED de signalisation
- 11 Fentes pour fixer la carte

**DEUTSCH****HAUPTKOMPONENTEN**

- 1 AnschlußKlemmenleiste
- 2 Hauptsicherung 5A
- 3 Zubehör-Sicherung 1A
- 4 Knöpfe zum Abspeicher der Radiocodes
- 5 Trimmer zur Einstellung Laufzeit
- 6 Trimmer zur Einstellung der Schließautomatik
- 7 Wählschalter für Funktionen mit 4 Dip (sehen S.22)
- 8 Wählschalter für Funktionen mit 10 Dip (sehen S.19)
- 9 Steckanschluß Funkfrequenz-Platine AF (sehen Tabelle)
- 10 LED Kontrolleuchte zur Anzeige
- 11 Lochung für die Befestigung der Karte

**ESPAÑOL****PRINCIPALES COMPONENTES**

- 1 Caja de bornes para las conexiones
- 2 Fusible de línea 5A
- 3 Fusible accesorios 1A
- 4 Teclas de memorización del código radio
- 5 Trimmer de regulación tiempo trabajo
- 6 Trimmer de regulación tiempo cierre automático
- 7 Selector de funciones con 4 dip (vedas pág.22)
- 8 Selector de funciones con 10 dip (vedas pág.19)
- 9 Conexión tarjeta radiofrecuencia AF (vedas tabla)
- 10 LED de señal
- 11 Perforaciones para fijación de la tarjeta

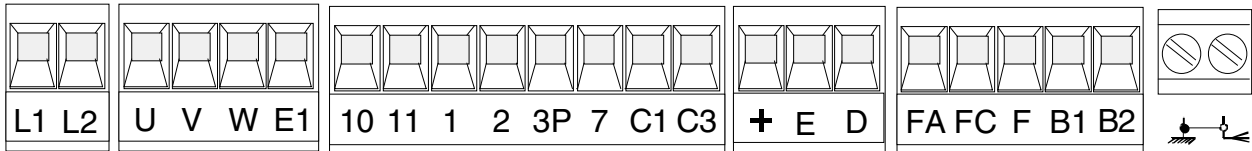

**Alimentazione 230V (a.c.)**

*230V (a.c.) power input*

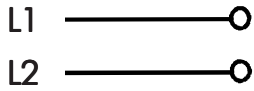

**Alimentation 230V (c.a.)**

*Stromversorgung 230V (Wechselstrom)*

**Alimentación 230V (a.c.)**

**Motore monofase 230V (a.c.)**

*230V (a.c.) single-phase motor*

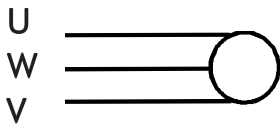

**Moteur monophasé 230V (c.a.)**

*Einphasenmotor 230V (Wechselstrom)*

**Motor monofásico 230V (a.c.)**

**Uscita 230V (a.c.) in movimento  
(es.lampeggiatore - max. 25W)**

*230V (a.c.) output in motion*

*(e.g. flashing light - max. 25W)*

**Sortie 230V (c.a.) en mouvement**

**(ex. branchement clignotant - max. 25W)**

*Ausgang 230V (Wechselstrom) in Bewegung*

*(z.B. Blinker-Anschluß - max. 25W)*

**Salida de 230V (a.c.) en movimiento**

**(p.ej. lámpara intermitente - max. 25W)**

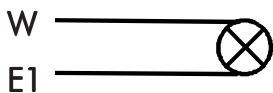
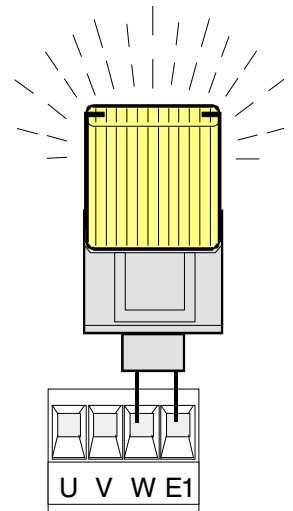

**Uscita 230V (a.c.) lampada ciclo - max. 60W**

*230V (a.c.) max.60W - cycle lamp*

**Sortie 230V (c.a.) lampe cycle - max. 60W**

*Ausgang 230V (Wechselstrom)*

*Betriebszyklus-Anzeigeleuchte - max.60W*

**Salida de 230V (a.c.) lámpara ciclo - max.60W**

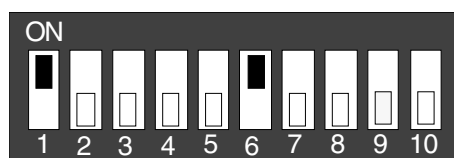
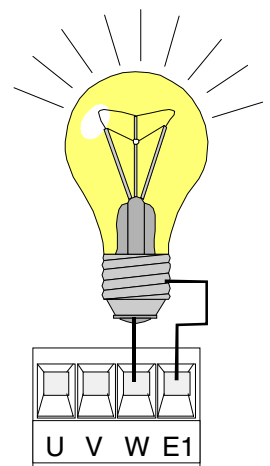

10  
11

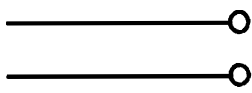

**Alimentazione accessori 24V (a.c.) max. 20W**

*24V (a.c.) Powering accessories (max 20W)*

**Alimentation accessoires 24V (c.a.) max. 20W**

*Zubehörspeisung 24V (Wechselstrom) max. 20W*

**Alimentación accesoios 24V (a.c.) max. 20W**

1  
2

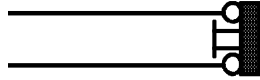

**Pulsante stop (N.C.)**

*Pushbutton stop (N.C.)*

**Bouton-poussoir arrêt (N.F.)**

*Stop-Taste (N.C.)*

**Pulsador de stop (N.C.)**

2  
3P

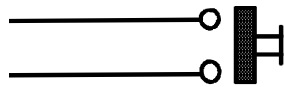

**Pulsante per apertura parziale (N.O.)**

*Button (N.O.) for partial opening*

**Bouton-poussoir (N.O.) pour ouverture partial**

*Taste (Arbeitskontakt) für TeilÖffnung*

**Pulsador (N.O.) para apertura parcial**

2  
7

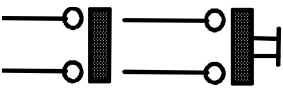

**Contatto radio e/o pulsante per comando  
(vedi dip pag.19-22)**

*Contact radio and/or button for control*

*(see dip pag.19-22)*

**Contact radio et/ou poussoir pour commande**

**(voir dip pag.19-22)**

*Funkkontakt und/oder Taste Steuerart*

*(sehen Dip Seite 19-22)*

**Contacto radio y/o pulsador para mando**

**(vedas dip pág.19-22)**

11  
FC

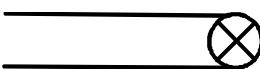

**Lampada spia (24V-3W max.) "cancello aperto"**

*(24V-3W max.) "gate-opened" signal lamp*

**Lampe-témoin (24V-3W max.) "portail ouverture"**

*Signallampe (24V-3W max.) "Tor Öffnen"*

**Lámpara indicadora (24V-3W max.) "puerta abierta"**

11  
FA

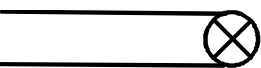

**Lampada spia (24V-3W max.) "cancello chiuso"**

*(24V-3W max.) "gate-closed" signal lamp*

**Lampe-témoin (24V-3W max.) "portail fermeture"**

*Signallampe (24V-3W max.) "Tor Schließen"*

**Lámpara indicadora (24V-3W max.) "puerta cierre"**

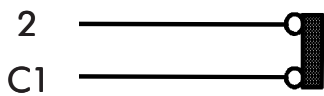

**Contatto (N.C.) di «riapertura durante la chiusura»**

*Contact (N.C.) for «re-opening during the closing»*

**Contact (N.F.) de «réouverture pendant la fermeture»**

*Kontakt (Ruhekontakt) «Wiederöffnen beim Schliessen»*

**Contacto (N.C.) para la «apertura en la fase de cierre»**

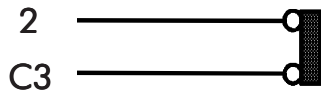

**Contatto (N.C.) di «stop parziale»**

*Contact (N.C.) for «partial stop»*

**Contact (N.F.) de «stop partiel»**

*Kontakt (Ruhekontakt) «Teilstop»*

**Contacto (N.C.) para la «parada parcial»**

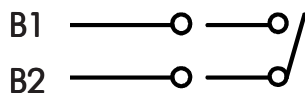

**Uscita contatto (N.O.) Portata contatto: 5A - 24V d.c.**

*Contact output (N.O.) Resistive load: 5A - 24V d.c.*

**Sortie contact (N.O.) Portée contact: 5A - 24V c.c.**

*Ausgang Arbeitskontakt Stromfestigkeit: 5A-24V Gleichstrom*

**Salida contacto (N.O.) Carga resistiva: 5A - 24V d.c.**

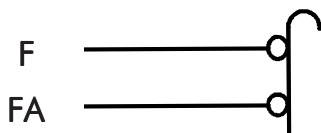

**Collegamento finecorsa apre**

*Connection limit switch opens*

**Connexion fin de course ouverture**

*Anschluß Endschallter Öffnung*

**Conexión fin de carrera apertura**

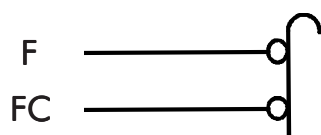

**Collegamento finecorsa chiude**

*Connection limit switch closes*

**Connexion fin de course fermeture**

*Anschluß Endschallter Schließung*

**Conexión fin de carrera cierre**

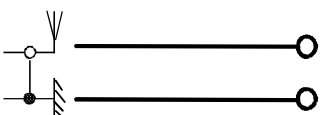

**Collegamento antenna**

*Antenna connection*

**Connexion antenne**

*Antennenanschluß*

**Conexión antena**

**DIP-SWITCH 10 VIE / 10-WAY DIP-SWITCH / DIP-SWITCH 10 VOIES**  
**ZEHNWEG-DIP-SWITCH / DIP-SWITCH 10 VÍAS**

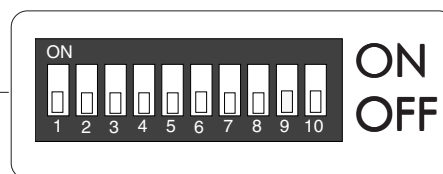
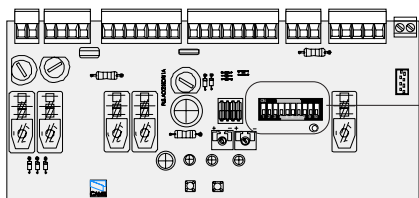

**ITALIANO**

- 1 ON** Chiusura automatica **attivata**; (1 OFF - disattivata)
- 2 ON** "Apri-stop-chiude-stop" con pulsante (2-7) e radiocomando (scheda AF inserita) **attivata**;
- 2 OFF** "Apri-chiude" con pulsante (2-7) e radiocomando (scheda AF inserita) **attivata**;
- 3 ON** "Sola apertura" con radiocomando (scheda AF inserita) **attivata**;
- (3 OFF - disattivata)
- 4 OFF** "Uomo presente" (esclude il funzionamento del radiocomando) **disattivata**;
- (4 ON - attivata)
- 5 ON** Prelampeggio **attivato**; (5 OFF - disattivato)
- 6 ON** Rilevazione di presenza ostacolo **attivata**; (6 OFF - disattivata)
- 7 OFF** Riapertura in fase di chiusura **attivata**; con dispositivo di sicurezza collegato ai morsetti 2-C1, (se non viene utilizzato il dispositivo, selezionare il dip in ON)
- 8 OFF** Stop parziale **attivata**; con dispositivo di sicurezza collegato ai morsetti 2-C3, (se non viene utilizzato il dispositivo, selezionare il dip in ON)
- 9 OFF** Stop totale **attivata** con dispositivo di sicurezza collegato ai morsetti 1-2, (se non viene utilizzato il dispositivo, selezionare il dip in ON)
- 10 OFF** Rallentamenti a finecorsa **attivati** (solo per cancelli fino a 300 Kg); con lettore ottico installato (10 ON- disattivati)

**NOTA:** le selezioni vanno eseguite a motore fermo in posizione di chiusura.

**ENGLISH**

- 1 ON** Automatic closure **activated**;  
(1 OFF-deactivated)
- 2 ON** "Open-stop-close-stop" with  
button (2-7) and radio control  
(AF board inserted) **activated**;
- 2 OFF** "Open-close" with button (2-7)  
and radio control (AF board  
inserted) **activated**;
- 3 ON** "Only opening" with radio control  
(AF board inserted) **activated**;  
(3 OFF-deactivated)
- 4 OFF** "Operator present" operation  
(radio remote control is  
deactivated when function is  
selected) **deactivated**;  
(4 ON -activated)
- 5 ON** Pre-flashing **activated**;  
(5 OFF-deactivated)
- 6 ON** Obstacle detection device  
**activated**; (6 OFF-deactivated)
- 7 OFF** Re-opening in closing phase  
**activated**; connect the safety  
device on terminals 2-C1, (if not  
used, set the dip-switch to ON)
- 8 OFF** Partial stop **activated**; connect  
the safety device on terminals 2-  
C3, (if not used, set the  
dip-switch to ON)
- 9 OFF** Total stop **activated**; connect  
the safety device on terminals 1-  
2, (if not used, set the dip-switch  
to ON)
- 10 OFF** Limit switch slowing **activated**  
(only for gates weighing up to  
300 kg); connect the optical  
reader (10 ON-deactivated)

**NOTE:** the selections should be carried out with the motor off in the closed position.

**FRANÇAIS**

- 1 ON** Fermeture automatique **activée**;  
(1 OFF-désactivée)
- 2 ON** "Ouvre-stop-ferme-stop" avec  
bouton (2-7) et commande-radio  
(carte AF insérée) **activée**;
- 2 OFF** "Ouvre-ferme" avec bouton (2-7)  
et commande-radio (carte AF  
insérée) **activée**;
- 3 ON** "Seulement ouverture" avec  
commande-radio (carte AF  
insérée) **activée**;  
(3 OFF-désactivée)
- 4 OFF** "Homme mort" (exclut la fonction  
radiocommande) **désactivée**;  
(4 ON-activée)
- 5 ON** Preclignotement **activée**;  
(5 OFF-désactivée)
- 6 ON** Dispositif de détection d'obstacle  
**activée**; (6 OFF-désactivée)
- 7 OFF** Réouverture en phase de  
fermeture **activée**; relier le  
dispositif de sécurité aux bornes  
2-C1; (s'il n'est pas utilisé,  
positionner l'interrupteur à  
positions multiples sur ON)
- 8 OFF** Stop partiel **activée**; relier le  
dispositif de sécurité aux bornes  
2-C3, (s'il n'est pas utilisé,  
positionner l'interrupteur à  
positions multiples sur ON)
- 9 OFF** Stop total **activée** relier le  
dispositif de sécurité aux bornes  
1-2, (s'il n'est pas utilisé,  
positionner l'interrupteur à  
positions multiples sur ON)
- 10 OFF** Ralentissement en fin de  
course **activée** (uniquement  
pour portails jusqu'à 300 Kg);  
relier lecteur optique (10 ON-  
désactivée)

**NOTE:** les sélections doivent être effectuées en position de fermeture quand le moteur est arrêté.

**DIP-SWITCH 4 VIE / 4-WAY DIP-SWITCH / DIP-SWITCH 4 VOIES**  
**VIERWEG-DIP-SWITCH / DIP-SWITCH 4 VÍAS**

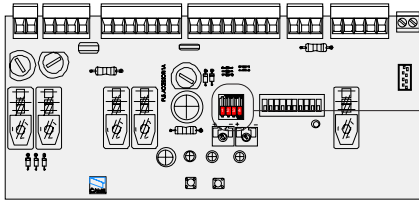

**ITALIANO**

- 1 ON "Sola chiusura" con dispositivo di comando collegato sul contatto 2-7 attivata;
- 1 OFF "Apre-chiude" con dispositivo di comando collegato su 2-7 (vedi dip 2 del selettore funzioni a 10 vie) attivata;
- 2 ON "Sola apertura" con dispositivo di comando collegato sul contatto 2-3P attivata;
- 2 OFF Apertura parziale attivata;
- 3 OFF Lettore ottico attivato; art. 001B4336 installato (3ON - disattivato);
- 4 ON Non connesso

**NOTA:** le selezioni vanno eseguite a motore fermo in posizione di chiusura.

**ENGLISH**

- 1 ON "Closing only" with a wireless control device connected to the 2-7 contact **activated**;
- 1 OFF "Open-close" with a wireless control device connected to the 2-7 contact (see the 10-way function selector dip 2) **activated**;
- 2 ON "Opening only" with a wireless control device connected to the 2-3P contact **activated**;
- 2 OFF Partial opening **activated**;
- 3 OFF Optical reader **activated**; item. 001B4336 connected (3ON - deactivated);
- 4 ON Not connected

**NOTE:** the selections should be carried out with the motor off in the closed position.

**FRANÇAIS**

- 1 ON "Uniquement fermeture" avec dispositif de commande branché sur le contact 2-7 activée;
- 1 OFF "Ouvre-ferme" avec dispositif de commande branché sur le contact 2-7 (voir commutateur à bascule 2 du sélecteur des fonctions à 10 voies) activée;
- 2 ON "Uniquement ouverture" avec dispositif de commande branché sur le contact 2-3-P activée;
- 2 OFF Ouverture partielle activée;
- 3 OFF Lecteur optique activée; art. 001B4336 branché (3ON - désactivée);
- 4 ON Non connecté

**NOTE:** les sélections doivent être effectuées en position de fermeture quand le moteur est arrêté.

**DEUTSCH**

- 1 ON "Nur Schließen" mit an Kontakt 2-7 angeschlossener Steuervorrichtung **aktiviert**;
- 1 OFF "Öffnen-Schließen" mit an Kontakt 2-7 angeschlossener Steuervorrichtung **aktiviert** (siehe Dip-Schalter 2 vom 10-Weg Funktionswählschalter);
- 2 ON "Nur Öffnen" mit an Kontakt 2-3P angeschlossener Steuervorrichtung **aktiviert**;
- 2 OFF Teilweises Öffnen **aktiviert**;
- 3 OFF Optischer Leser **aktiviert**; art. 001B4336 angeschlossener (3ON - deaktiviert);
- 4 ON nicht angeschlossen

**HINWEIS:** Die Schalter nur bei abgeschaltetem Motor und geschlossenem Tor betätigen.

## ESPAÑOL

- 1 ON "Sólo cierre" con dispositivo de mando conectado en el contacto 2-7 activo;
- 1 OFF "Abrir-cerrar" con dispositivo de mando conectado en 2-7 (véase dip 2 del selector de funciones de 10 vías) activo;
- 2 ON "Sólo apertura" con dispositivo de mando conectado en el contacto 2-3P activo;
- 2 OFF Apertura parcial activo;
- 3 OFF Lector óptico activo; art. 001B4336 conectado (3ON - desactivado);
- 4 ON No conectado

**NOTA:** las selecciones se realizan con el motor parado en posición de cierre.

## REGOLAZIONI - ADJUSTMENTS - RÉGLAGES - EINSTELLUNGEN - REGULACIONES

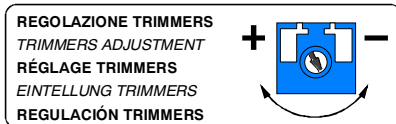
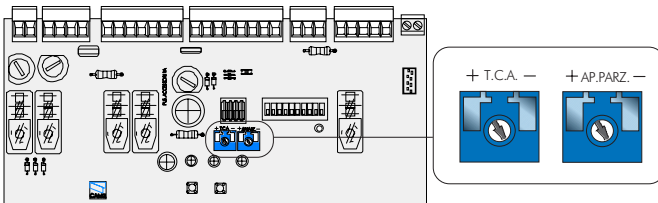

## ITALIANO

**Trimmer T.C.A.** = Regolazione tempo di chiusura automatica da un minimo di 0 secondi a un massimo di 120 secondi.  
**Trimmer AP.PARZ.** = Regolazione di apertura parziale da un minimo di 0 secondi a un massimo di 16 secondi.

## ENGLISH

**Trimmer T.C.A.** = Adjusts automatic closing time from a minimum of 0 seconds to a maximum of 120 seconds.  
**Trimmer AP.PARZ.** = Adjusts partial opening from a minimum of 0 seconds to a maximum of 16 seconds.

## DEUTSCH

**Trimmer T.C.A.** = Timer, auf dem die Verzögerung für das automatische Schließen mit mindestens 0 Sekunden und höchstens 120 Sekunden eingestellt werden kann.  
**Trimmer AP.PARZ.** = Timer, auf dem die Verzögerung für das Teilöffnung mit mindestens 0 Sekunden und höchstens 16 Sekunden eingestellt werden kann.

## FRANÇAIS

**Trimmer T.C.A.** = Réglage du temps de fermeture automatique d'un minimum de 0 secondes à un maximum de 120 secondes.  
**Trimmer AP.PARZ.** = Réglage d'ouverture partial d'un minimum de 0 secondes à un maximum de 16 secondes.

## ESPAÑOL

**Trimmer T.C.A.** = Regulación del tiempo de cierre automático, desde un mínimo de 0 segundos hasta un máximo de 120 segundos.  
**Trimmer AP.PARZ.** = Regulación de apertura parcial, desde un mínimo de 0 segundos hasta un máximo de 16 segundos.

## COLLEGAMENTO PER 2 MOTORI ABBINATI - CONNECTIONS FOR 2 COMBINED MOTORS

### CONNEXIONS POUR 2 MOTEURS ACCOUPLES

### ANSCHLUSSE FÜR 2 PARALLELGESCHALTETEN MOTOREN - CONEXIÓN PARA 2 MOTORES ACOPLADOS

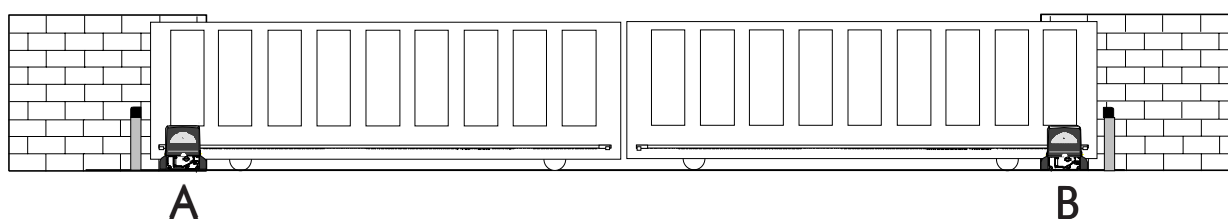

#### ITALIANO

Nel caso d'installazione di due motori abbinati, procedere nel seguente modo:

- Coordinare il senso di marcia dei motoriduttori "A" e "B", modificando la rotazione del motore "B" (vedi collegamento finecorsa);
- Assicurarsi che sia inserito il ricevitore radio (AF) sul quadro del motore "A" (1);
- Su entrambi i quadri devono essere fatte le stesse regolazioni e funzioni (2);
- Eseguire i collegamenti elettrici tra le morsettiere del quadro "A" e "B" come da «Fig. A»;
- Il pulsante di apertura parziale (2-3P) va collegato sulla morsettiera del quadro del motore interessato;

**N.B.** Per comandare le automazioni con l'utilizzo del radiocomando occorre, memorizzare il codice del trasmettitore sul canale CH2 della scheda base del motore "A" (vedi programmazione radiocomando). Dopo aver memorizzato il codice, collegare i contatti B1-B2 con 2-7. Il comando di apertura sarà di tipo «apre-chiude», «apre-stop-chiude-stop» o «solo apertura», secondo la disposizione dei dip 2-3, selezionati su entrambe le schede.

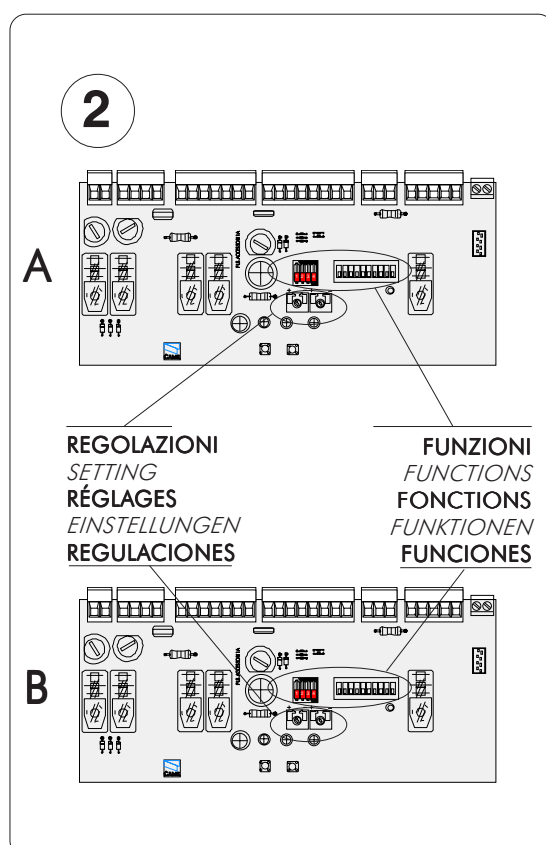
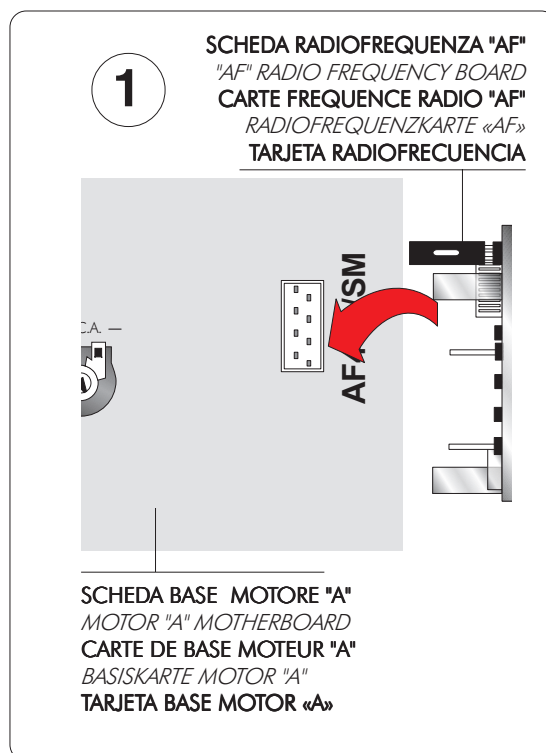

## ENGLISH

In case two combined motors are installed, proceed in the following manner:

- Coordinate the direction of the "A" and "B" gearmotors, modifying the rotation of motor "B" (see limitswitch setting);
- Make sure that the (AF) radio receiver is connected to the motor "A" control panel (1);
- The same settings and functions must be made on both control panels (2).
- Make the necessary electric connections between the terminal boards of the "A" and "B" panels as in «Fig. A»;
- The partial aperture button (2-3P) should be connected to the terminal board of the corresponding motor control panel;

**N.B.** To control the automatic gate with the wireless control, it is first necessary to memorise the transmitter code on channel CH2 of the motor "A" motherboard (see programming remote control). After memorising the code, connect contacts B1-B2 with 2-7. The opening command will be of type «open-close», «open-stop-close-stop» or «open only», depending on the dip 2-3 settings, selected on both boards.

## FRANÇAIS

Pour installer deux moteurs accouplés, procéder comme suit:

- Coordonner le sens de marche des motoréducteurs "A" et "B" en modifiant la rotation du moteur "B" (voir programmation interrupteur de fin de course);
- Contrôler si le récepteur radio (AF) est branché sur le carte de base du moteur "A" (1);
- Les mêmes réglages et fonctions doivent être effectués sur les deux tableaux (2).
- Effectuer les branchements électriques entre les plaques à borne du tableau "A" et "B", comme indiqué sur la «Fig. A»;
- Brancher le bouton d'ouverture partielle (2-3P) à la plaque à bornes du tableau du moteur intéressé;

**N.B.** Pour commander les automatismes à l'aide de la radiocommande, mémoriser le code de l'émetteur sur le canal CH2 de la carte de base du moteur "A" (voir programmation commande radio). Après avoir mémorisé le code, brancher les contacts B1-B2 à 2-7. La commande d'ouverture sera du type «ouvre-ferme», «ouvre-arrêt-ferme-arrêt» ou «uniquement ouverture», selon la disposition des commutateurs à bascule 2-3 sélectionnés sur les deux cartes.

**FIG. A**  
**ABB. A**

**Morsettiera del quadro motore «A»**

*Terminal board of the "A" motor control panel*

**Plaque à bornes du tableau du moteur «A»**

*Klemmbrett der Schalttafel vom Motor «A»*

**Tablero de bornes del cuadro motor «A»**

**Morsettiera del quadro motore «B»**

*Terminal board of the "B" motor control panel*

**Plaque à bornes du tableau du moteur «B»**

*Klemmbrett der Schalttafel vom Motor «B»*

**Tablero de bornes del cuadro motor «B»**

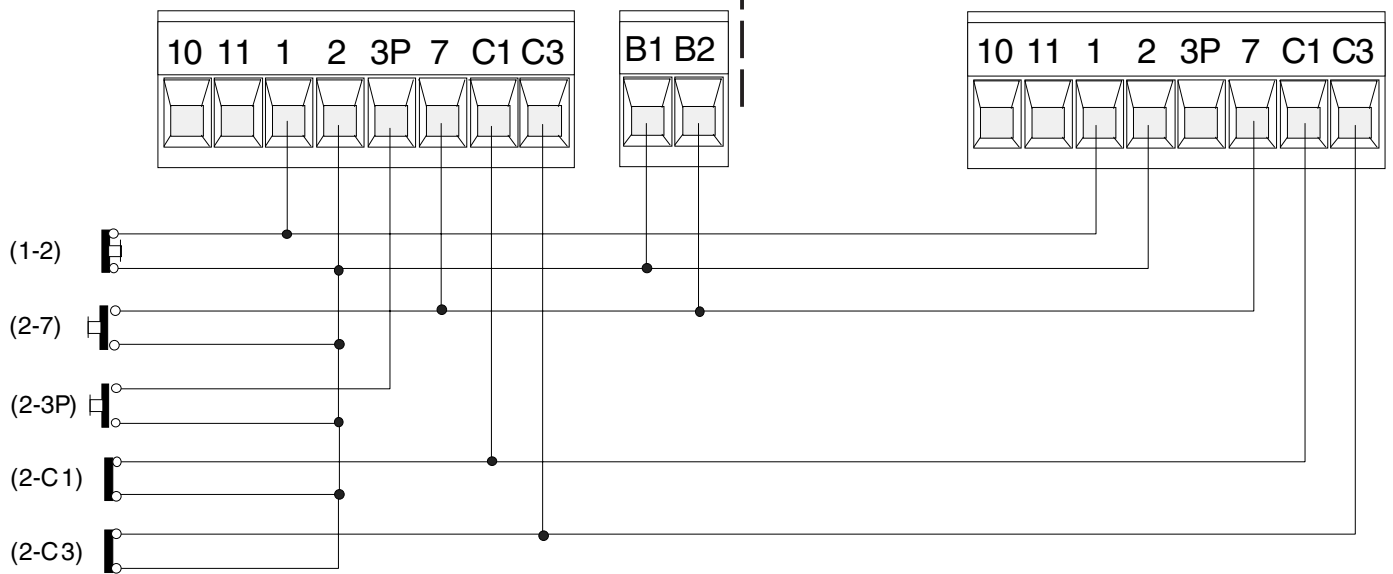

**ITALIANO**

Gruppo motore-finecorsa già collegati per montaggio a sinistra vista interna.  
 Per eventuale montaggio a destra:

- invertire FA-FC dei finecorsa sulla morsettiera;
- invertire le fasi U-V del motore sulla morsettiera.

**ENGLISH**

The motor and limit switch unit are wired at the factory for mounting on the left-hand side of the gate (as seen from the inside). If right-hand installation is desired:

- invert limit switch connections FA-FC on the terminal block;
- invert motor phase connections U-V on the terminal block.

**FRANÇAIS**

Groupe moteur-fins de course déjà branchés pour le montage à gauche - vue de l'intérieur.

Pour un éventuel montage à droite:

- inverser FA-FC des fins de course sur la plaque à bornes;
- inverser les phases U-V du moteur sur la plaque à bornes.

**DEUTSCH**

Das Motor-Anschlag-Aggregat schon für die Montage auf der linken Seite angeschlossen, interne Ansicht.

Für eine eventuelle Montage auf der rechten Seite:

- die Öffnungs- und Schließungsphasen auf dem Klemmbrett invertieren;
- die U-V Phasen des Motors auf dem Klemmen tauschen.

**ESPAÑOL**

Grupo motor-fin de carrera ya conectados para el montaje a la izquierda vista interior.  
 Para el eventual montaje a la derecha:

- invertir FA-FC de los fines de carrera en el cuadro de bornes;
- invertir las fases U-V del motor en el cuadro de bornes.

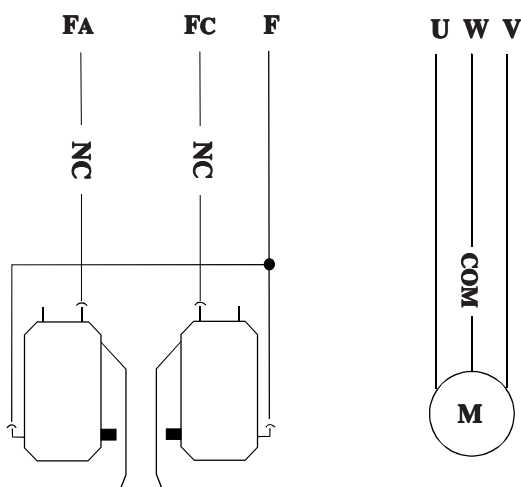

**Gruppo finecorsa**  
 Limit switch unit  
**Groupe fins de course**  
 Anschlag-Gruppe  
**Grupo fin de carrera**

**Motore monofase 230V**  
 230V single-phase motor  
**Moteur monophasé 230V**  
 Einphasiger Motor 230V  
**Motor monofásico de 230V**

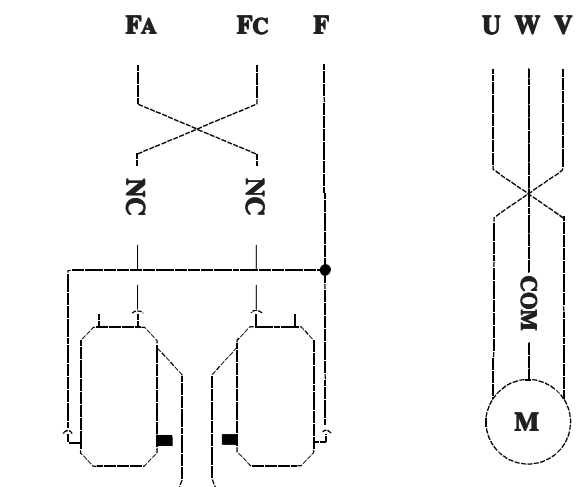

**Gruppo finecorsa**  
 Limit switch unit  
**Groupe fins de course**  
 Anschlag-Gruppe  
**Grupo fin de carrera**

**Motore monofase 230V**  
 230V single-phase motor  
**Moteur monophasé 230V**  
 Einphasiger Motor 230V  
**Motor monofásico de 230V**

LIMITATORE DI COPPIA MOTORE / MOTOR TORQUE LIMITER / LIMITEUR DE COUPLE MOTEUR  
DREHMOMENTBEGRENZER DES MOTORS / LIMITADOR DE PAR MOTOR

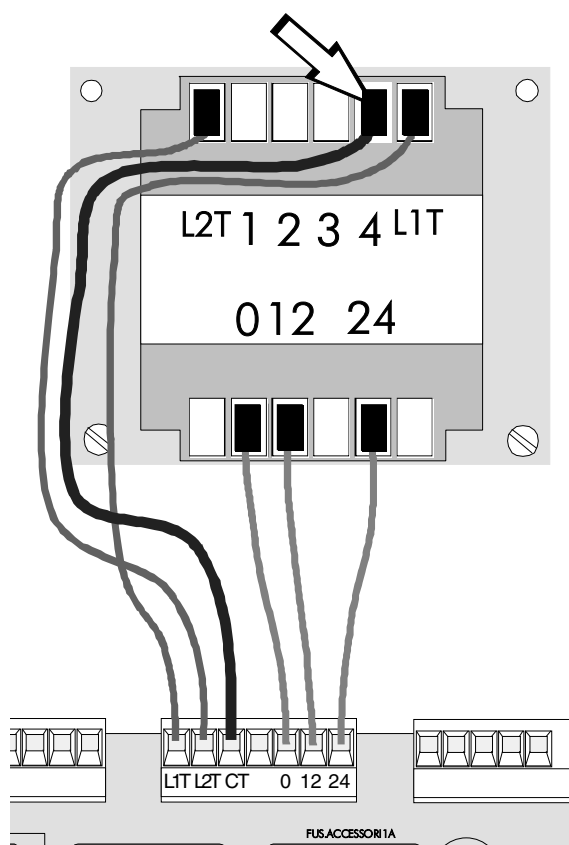

**ITALIANO**

Per variare la coppia motrice, spostare il faston indicato (con filo di colore nero) su una delle 4 posizioni; 1 min. - 4 max

**ENGLISH**

To vary the motor torque, move the indicated faston to one of the four positions: 1=min, 4=max

**FRANÇAIS**

Pour varier le couple du moteur, déplacer le connecteur indiqué sur l'une des 4 positions; 1 min. - 4 max.

**DEUTSCH**

Zur Änderung des Motor-Drehmoments den angegebenen Faston auf eine der 4 Stellungen positionieren: 1 min. - 4 max.

**ESPAÑOL**

Para variar el par motor, desplazar el faston indicado hasta una de las 4 posiciones; 1 mín. - 4 máx.

**NOTE - NOTE - NOTE - HINWEIS - NOTA**



ASSISTENZA TECNICA  
NUMERO VERDE  
☎ 800 295830  
WEB  
[www.came.it](http://www.came.it)  
E-MAIL  
[info@came.it](mailto:info@came.it)



**CAME CANCELLI AUTOMATICI S.P.A.**  
DOSSON DI CASIER (TREVISO)  
☎ (+39) 0422 ☎ (+39) 0422 490944

**CAME LOMBARDIA S.R.L.** COLOGNO M. (MI)  
☎ (+39) 02 26708293 ☎ (+39) 02 25490288  
**CAME SUD S.R.L.** NAPOLI  
☎ (+39) 081 752445 ☎ (+39) 081 7529109  
**CAME (AMERICA) L.L.C.** MIAMI (FL)  
☎ (+1) 305 5930227 ☎ (+1) 305 5939823  
**CAME AUTOMATISMOS S.A.** MADRID  
☎ (+34) 091 5285009 ☎ (+34) 091 4685442  
**CAME BELGIUM** LESSINES  
☎ (+32) 068 333014 ☎ (+32) 068 338019

**CAME FRANCE S.A.** NANTERRE CEDEX (PARIS)  
☎ (+33) 01 46130505 ☎ (+33) 01 46130500  
**CAME GMBH** KORNTAL BEI (STUTTGART)  
☎ (+49) 07 11839590 ☎ (+49) 07 118395925  
**CAME GMBH** SEEFELD BEI (BERLIN)  
☎ (+49) 03 33988390 ☎ (+49) 03 339885508  
**CAME PL SP.ZO.O.** WARSZAWA  
☎ (+48) 022 8699933 ☎ (+48) 022 6399933  
**CAME UNITED KINGDOM LTD** NOTTINGHAM  
☎ (+44) 01159 387200 ☎ (+44) 01159 382694